

Main Locking Plate, solid, non-rebated

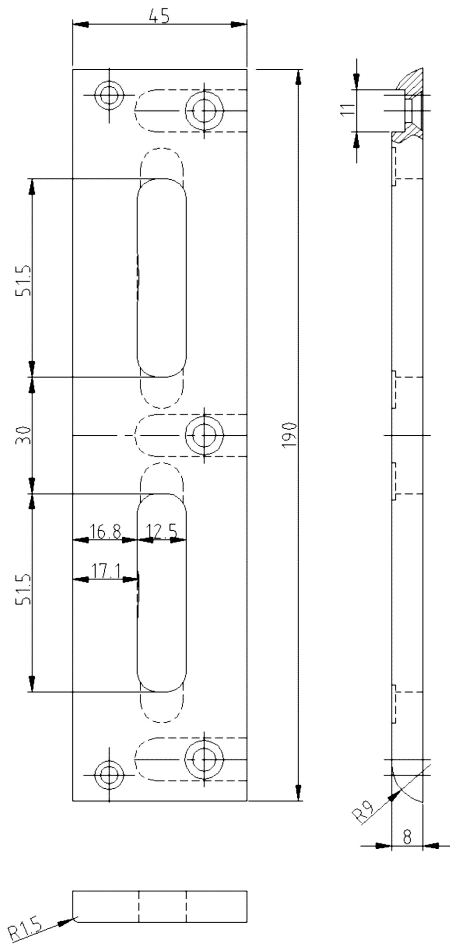

Additional Information

Application: Striking plate for flush doors/face frames, has to be recessed, made of solid steel, suitable for all DIN locks, for heavy duty doors according to RC2 or RC3

Accessories: STABILO® safety plates and plastic lining System1

Section Drawing

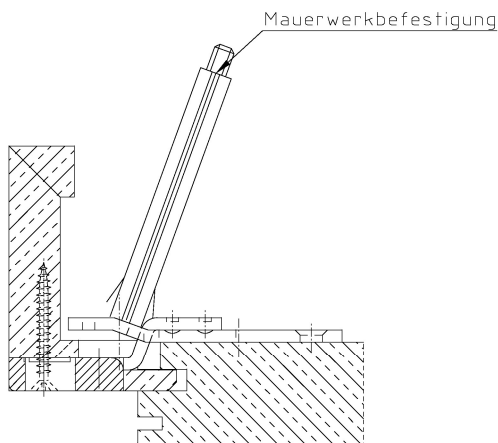

Item	Finish	PU Remark
039276	Sterling silver	10 SBL 45 2-Loch schwer